

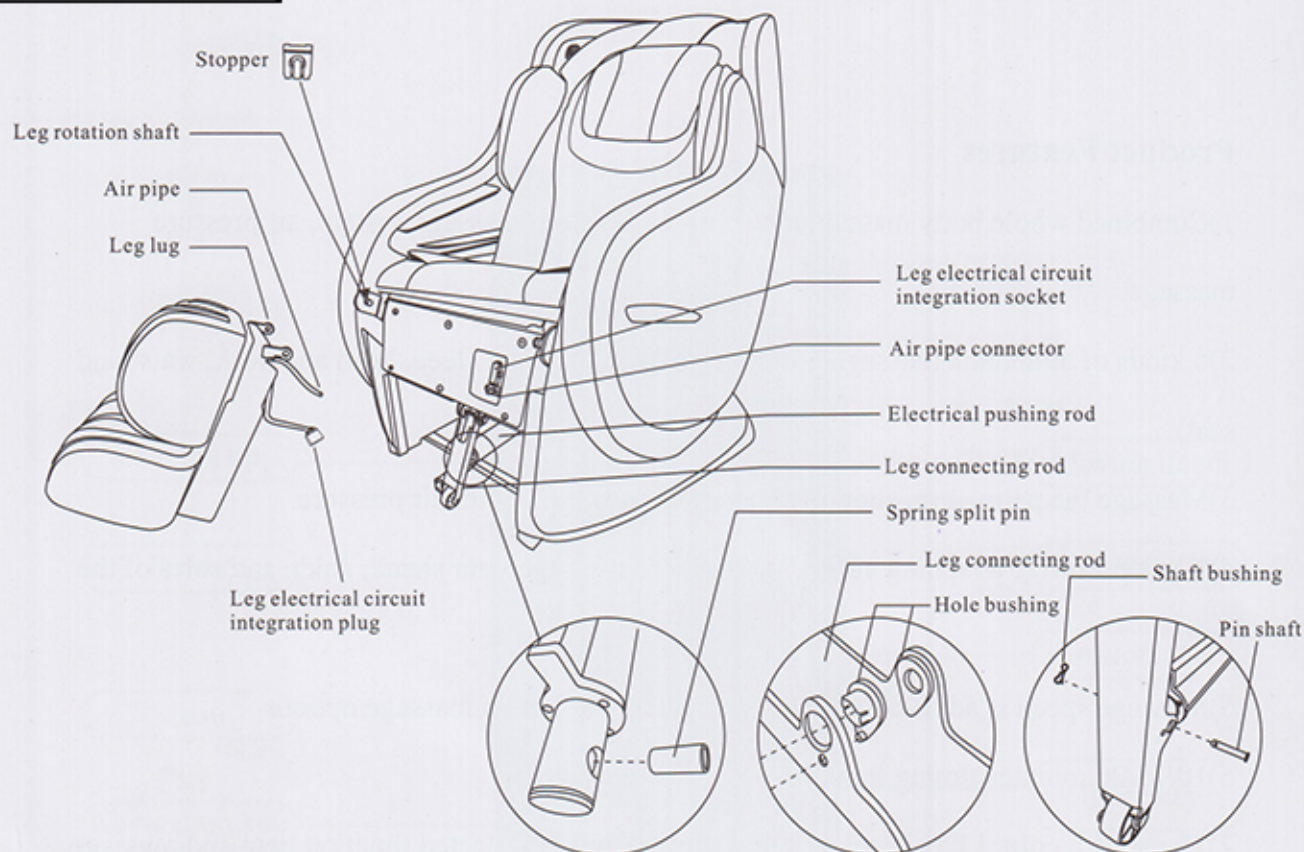

**Best Master Furniture™**  
The Imported Furniture Specialist

## Installation Instruction

ITEM#: 8800



1. First insert the shaft bushing into the round hole in the front of the electric pushing rod, then insert the hole bushing into the hole in the leg connecting rod, insert the pin shaft into the leg connecting rod and the electric pushing rod, and then insert the spring split pin into the pin shaft hole.
2. Put one side of the leg's lug onto the leg rotation shaft of the chair, and then put another end onto the corresponding leg rotation shaft, and vertically insert the stopper into the groove in the leg rotation shaft.
3. Insert the air pipe above the leg into the air pipe connector on the seat body, and insert the leg electric circuit integration plug into the leg electric circuit integration socket.
4. Insert the power supply into the power supply socket at the back of the chair, and insert the hand controller into the corresponding hole, and turn on the power to use.

